

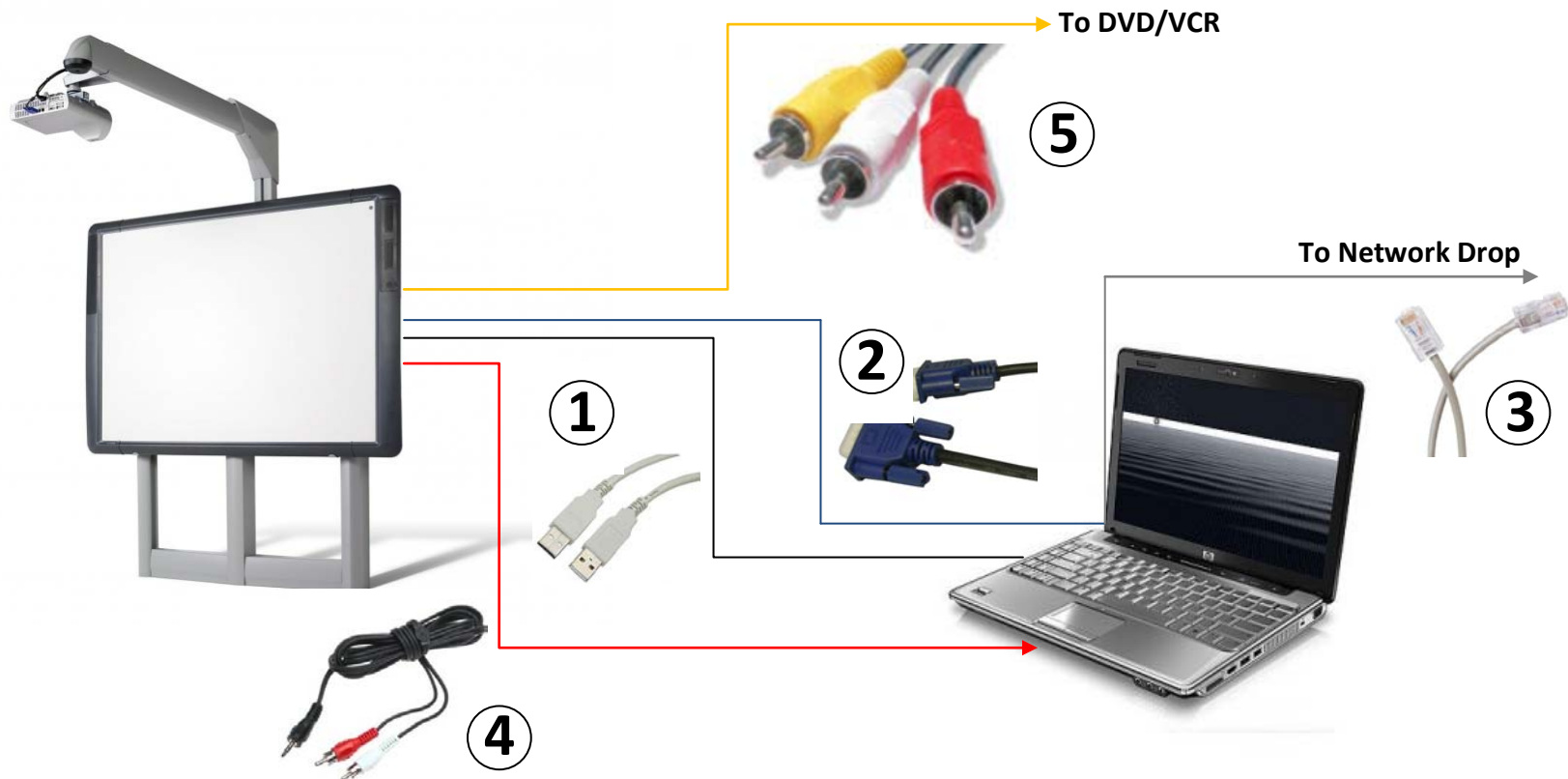









The Interactive Whiteboard System

There are a limited number of parts that complete the interactive whiteboard system. This simplifies the troubleshooting process as there are a limited number of possibilities to troubleshoot. The main components are the Activboard and the computer. Here is a simple diagram to explain the components and how they are connected to make the board work. Checking these connections are always the first steps in troubleshooting problems.



①	USB cable connection	 Allows the pen (physical point) to interact with the computer on the Activboard.
		 Allows the pen (physical point) to interact with the computer on the Activboard. The USB also powers the board and transmits the sound signal to the speakers from the computer.
②	VGA cable connection	 Sends the image to the projector.
③	Ethernet (network) cable	 Provides internet and network access. It is recommended to be connected to the network, but it is not required to use the Activboard.
④	Sound cord	 Connects laptop sound (headphones jack) to attached speakers. Volume can be adjusted from the computer and wall box.
		 Sound for these boards run through the USB cable. This can then be used to route a stereo/boom box or iPod through the attached speakers as well.
⑤	RCA cords	 The Activboard can become your classroom TV (run through the DVD/VCR). Connect the RCA cords to a DVD/VCR. To view TV or movies through the DVD/VCR, be sure to change the input on the projector from Computer to Video.

Podcasts support these topics. Visit or subscribe at <http://wiki.washoe.k12.nv.us/groups/activboards>.
